

Warning. Oil Pipe line traverses carriageway in this location. Contact Fisher German Tel 01530 412821 at least 48hrs prior to breaking ground.

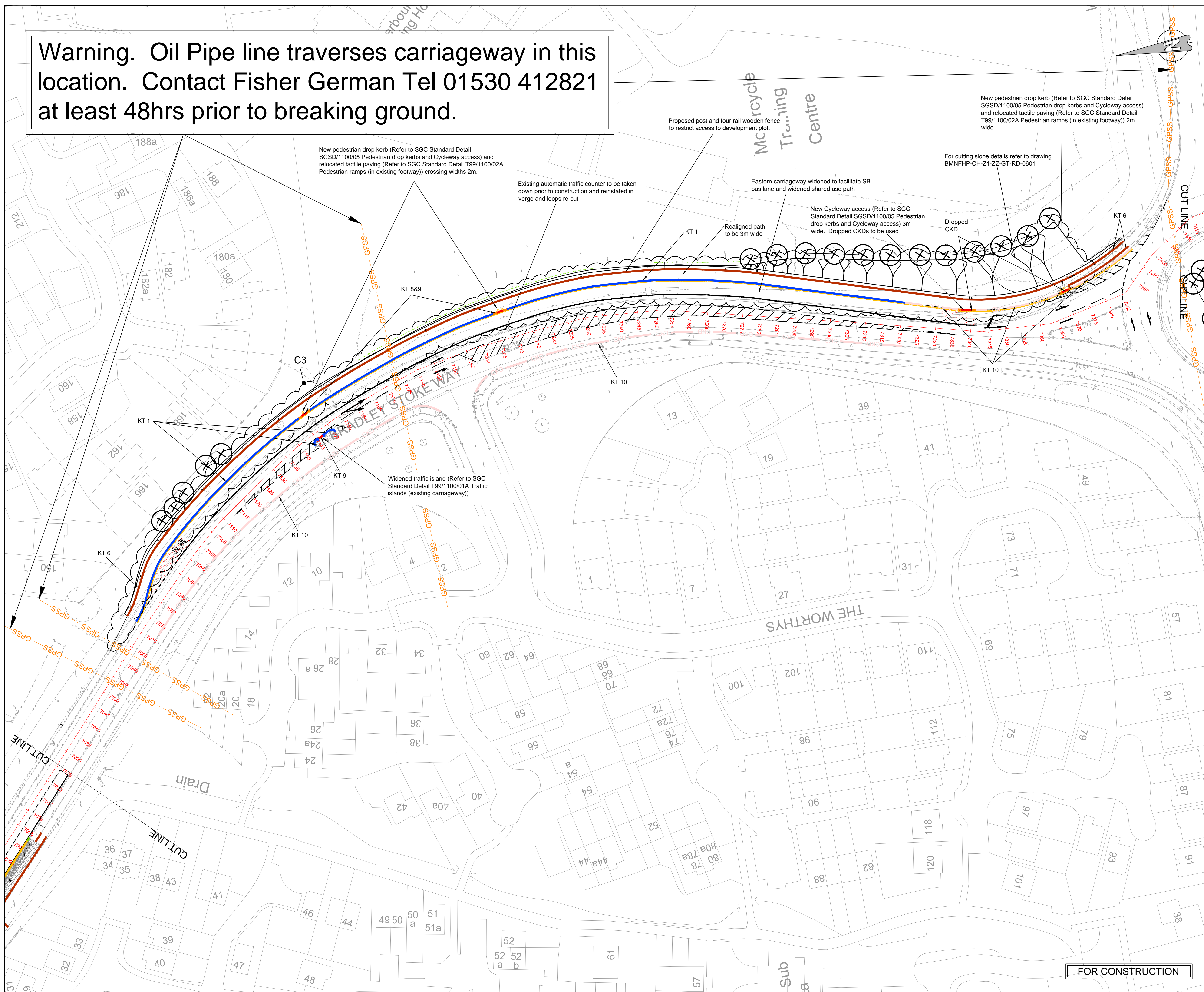

© Crown copyright and database rights 2014 Ordnance Survey 100023410.
 This map has been provided for this drawing and must not be used for any other purpose. Only one paper copy may be made for your own use.

Key

- Bus lane
- Re-graded grassed area
- Earthworks (Embankment / cutting)
- Half Battered kerb (KT 1) - 125mm upstand (Refer to SGC standard detail SGSD/1100/01 Type KA2 Kerbs)
- Splay kerb (KT 2) - 125mm upstand (Refer to SGC standard detail SGSD/1100/01 Type KA2 Kerbs)
- Transition bus stop kerb (KT 3) - (Refer to Charcon Product Specification)
- Bus Stop Kerb 180mm upstand (KT 4) (BCC SD02-002 B)
- Timber Edging Kerb (KT 5) (BCC SD 02-005 B)
- Edging Kerb (KT 6) (Refer to SGC standard detail SGSD/1100/02 Type EA1 Channels and Edgings)
- Drainage Channel (KT 7) (Refer to SGC standard detail SGSD/1100/02 Channels and Edgings)
- Transition Kerb (Half battered) (KT 8) (For details of type BN, type DL1/2 and type DR1/2, refer to BS.7263: Part 3)
- Dropped Kerb (Half battered) (KT 9) (Refer to SGC standard detail SGSD/1100/01 Type PDK2 Kerbs)
- Combined Kerb Drainage (KT 10) (Refer to Drainage drawings)
- Half Battered Kerbs and SuDs Weir Kerbs (KT 11) (Refer to Drainage drawings)

Note: All Kerbs adjacent to carriageway edge will require sufficient sub-base haunch as shown on SD 01-008 B

Proposed Pedestrian Guard Rail (PB) (Refer to SGC standard detail SGSD/400/02 Pedestrian Guard Rail steel welded and appendix 4/1)

Proposed Traffic sign

Vehicle restraint system (VRS) Refer to Specification Appendix 4/1

Proposed Traffic Signals

Proposed Gullies

Buff/ Red Tactile paving (Refer to SGC standard detail SGSD/1100/12C and SGSD/1100/05)

Proposed Newt Fencing (NF) and Gate through newt fencing (NG). Refer to drawing BMNFHP-CH-Z1-ZZ-DR-102, BMNFHP-CH-Z1-ZZ-DR-041 & Specification Appendix 3/1

Temporary Heras Fencing (TF). Refer to Specification Appendix 3/1

Timber Post and Rail Fence. Refer to Highway Construction Details Drg. No. H3

General scheme channage. (For specific master string channage, refer to setting out details)

Notes

- All dimensions are in meters unless noted otherwise.
- This drawing should not be scaled and only written dimensions should be used.
- For Traffic Sign details refer to drawings BMNFHP-CH-Z1-C1-DR-1231-1244
- For Road Marking details refer to drawings BMNFHP-CH-Z1-C1-DR-RD-1201-1214
- For Traffic Signal details refer to drawings BMNFHP-CH-Z1-SLZ-C1-DR-SL-1221-1229
- For Landscape details refer to drawings BMNFHP-CH-Z1-LZ-C1-DR-L-0001-0015
- For Drainage details refer to drawings BMNFHP-CH-Z1-DZ-DR-D-0501-0535
- For Kerbs, VRS, Bus stop and fencing details refer to drawings BMNFHP-CH-Z1-C1-DR-RD-0001-0033
- For Site Clearance details refer to drawings BMNFHP-CH-Z1-C1-DR-Z-0201-0214
- For Tree Planting details refer to drawings BMNFHP-CH-Z1-LZ-C1-DR-L-0001-0016
- For Pavement details refer to Drawings BMNFHP-CH-Z1-C1-DR-RD-700-713

C3	AC	PF	PF	08/11/2016	Updated as per latest design (access proposal to Pasternon Homes)
C2	AC	PF	BS	03/06/2015	Proposed post and four rail wooden fence
C1	AC	PF	BS	12/06/2015	Update as per latest design and split out paving to new set of drawings 2/20 series

Rev	By	Chkd	Apprvd	Date	Description

Client: **West of England** travel

CH2M HILL
 1 The Square Temple Quay Bristol BS1 6DQ
 Tel +44 (0)117 910 2580 Fax +44 (0)117 910 2581
 www.halcrow.com

Project: **NORTH FRINGE TO HENGROVE METROBUS**

Drawing: **ZONE 01 GENERAL ARRANGEMENT KERBS AND STREET FURNITURE**

Drawn by: AC Date: 26/06/2014
 Checked by: PGF Date: 17/07/2014
 Approved by: BS Date: 21/07/2014

Drawing No. **BMNFHP-CH-Z1-C2-DR-RD-0011 - A** Revision **C3**

Drawing Scale: 1:500 @ A1

FOR CONSTRUCTION

Drawing file path & name: U:\Projects\20288\...x\NFHP_Zone_180_CAD_Drawings\02_Drawing\Temp\Cons Drawings - Pasternon Homes\BMNFHP-CH-Z1-C2-DR-RD-0011 - A.dwg
 Xref file path: U:\Projects\20288\...x\NFHP_Zone_180_CAD_Drawings\02_Drawing\Temp\Cons Drawings - Pasternon Homes\BMNFHP-CH-Z1-C2-DR-RD-0011 - A.dwg
 User and Pkg Code: ...